



USER GUIDELINE

Thank you for choosing MOON light!

*For using this product safely and conveniently and keeping it well-preserved, please read this manual carefully before using. Please save this manual for future reference.

*Due to the improvement of the product, the product you bought may not be exactly in accordance with the introduction of this manual. We apologize for that.

SPECIFICATION

*1 pc Multi color COB high brightness LED

*Rechargeable lithium polymer battery (3.7V 800 mAh)

*CNC aluminium heat sink casing

*USB remote control system

*4 phases total 16 modes:

Low / Standard / High / Over drive /

10% Flashing / 50% Flashing / 100% Flashing / Strobe

Low Chameleon / High Chameleon

Blue / Green / Red / Yellow / Purple / White

*Quick release universal bracket RB-22

(fits all round bars and AERO style bars)

*2 O-rings for mounting: RS-G (fits 20-35mm diameters)

RS-H (fits 35-52mm diameters)

*Quick release saddle rail mount

*Low battery, charging and fully charged indicator

*Automatic fully charged cut-off system

*Side visibility

*Water resistant (IPX 4)

*Water resistant usb port

*Belt clip design

(can be installed either on saddle bag, jersey back pocket, etc.)

CONTENTS INCLUDED



Content:

Chameleon-Nebula

* RB-22 (Universal bracket)

* 2 O-rings for mounting:

RS-G(fits 20-35mm diameters)

RS-H(fits 35-52mm diameters)

* BK-21 (Belt clip)

* RB-21 (Saddle rail bracket)

* USB-WP (Water resistant USB cable)

Optional accessories:

* RB-23 (Helmet bracket)

* USB-RM-1200 (USB remote control 1200mL)

HOW TO MOUNT THE LIGHT

1. Choose the strap to fit in the bar.
2. Make sure the strap is click in place of the hook.
3. Hold the light on the handle bar/seat post.
4. Wrapping rubber strap around bar and stretching strap around hook to secure.
5. Slide the light forward onto bracket until it clicks into place.
6. Press down release lever to remove.

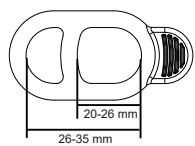

RS-G
20-35 mm

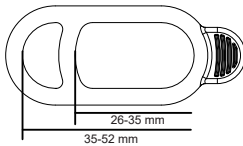

RS-H
35-52 mm

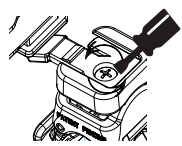
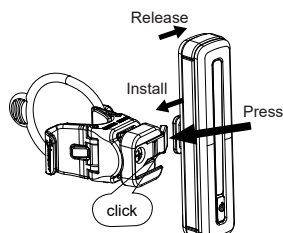
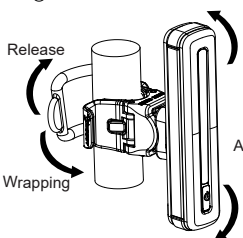
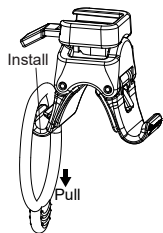

7. Adjust the horizontal/vertical beam angle when mounted on the handle bar/seatpost, loosen the screw knob and spin the light left to right / band the light up or down for your preferred angle, then tighten the screw knob to secure the light in place.

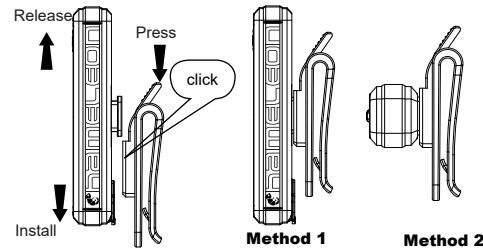

1. Slide light forward onto belt clip until it clicks into place.
2. Press down release lever to remove.

HOW TO MOUNT THE TAILLIGHT

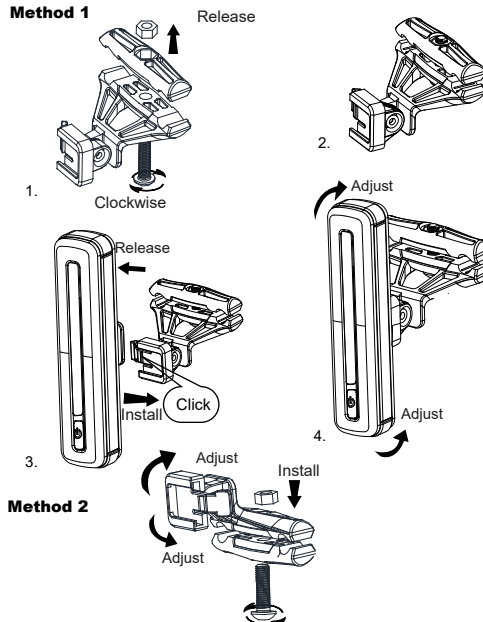

1. Loosen the screws in the saddle bracket with the Allen key.
2. Clamp the bracket onto the saddle rail.
3. Align the screw holes, using the Allen key to tighten the bracket.
4. Slide light forward onto bracket until it clicks into place.
5. Press down release lever to remove.
6. Twist the light body to adjust the vertical angle.

LIGHT OPERATION

1. Press the power button to select the mode:

In this method four modes are cycled.

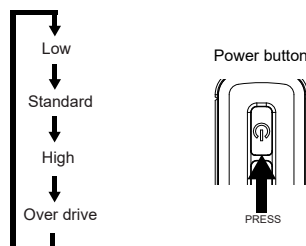

2. Press and hold the on / off button around 1 second to turn off.

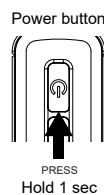

3. Fast press two times the power button to change into the next phases. Total 4 phases are cycled.

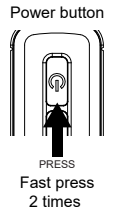
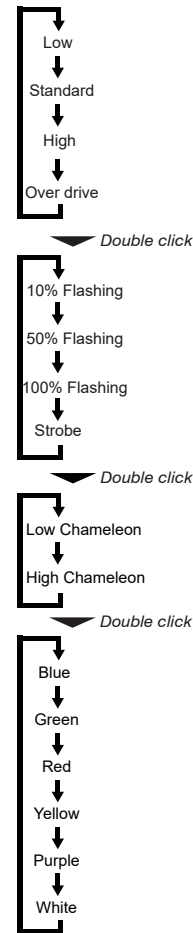

BEAM ADJUSTMENT

To adjust the horizontal beam, spin the headlight left to right for your best side to side beam angle. To adjust the vertical beam angle, loosen the mounting and rotate the light up and down to your best vertical beam angle, then tighten the mounting.

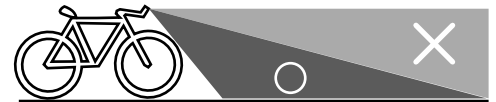

The beam is widely dispersed, besides its high brightness. To prevent from blinding the oncoming vehicles on the public roads, you'd better adjust the angle downward.

REMOTE SWITCH OPERATION

1. Press the power button to choose the modes:

In this button control four modes are cycling in loop.

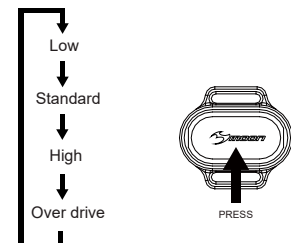

2. Press and hold the on / off button around 1 second to turn off the light.

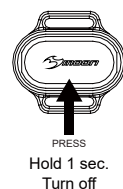

2. Fast press two times the power button to change into the next phases. Total 4 phases are cycled.

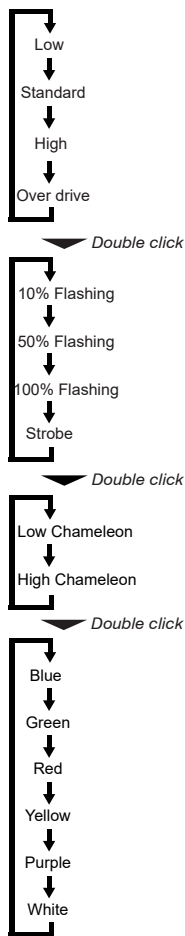

REMOTE SWITCH MOUNTING

1. Put one end of the belt go through the cycle handle bar
2. Align to the controller button and pass through.
3. Please pull the Velcro ends tightly.

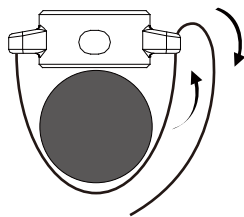

HOW TO CHARGE BATTERY

Attention: If you do not use the battery for a long time, be sure to make it a fully recharge every 3 months before storing again. Please keep the battery in cool and dry place when storing. Once you start using the light, you'd better keep using it.

Charging indicator
*Flashing Blue - charging

*Steady Blue - charged

Low battery indicator
*Flashing Blue - Low

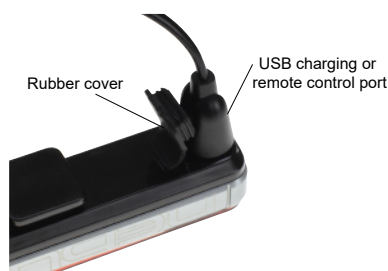
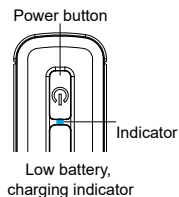

1. Find the charging place at the back of the light.
2. Lift the rubber cover and you'll see the charging port.
3. Plug the USB cable to your computer USB port.
4. Plug the charger cable to the light charger port.

5. The charging indicator shows slow flashing blue when the light is charging, after fully charged it changes to steady.

6. It is normal that the battery may get high temperatures during charging (up to 104°F/40°C), as the chemical in battery is in reaction. If the battery is not drained completely before charging, it may also get warm.

7. Several factors can influence the battery's durability: type of cell strain, the maintenance routine, the temperature and etc. Normally speaking, the higher the battery capacity, the longer the burn time.

8. The battery capacity may become ineffective about 80% of its value after 300-500 charge/discharge cycles. The battery may have 3 years life span under good care.

9. The battery voltage and capacity decrease apparently at low temperatures, especially near or below ice point. The capacity decreases 5%-10% at freezing (burn time decreases 50%). At -20°C, the capacity decreases 30% (burn time decreases 70%). The battery performance will return normal when the temperate gets up to 70°F/20°C. The battery will lose around 1% of its capacity per day when you store the battery at normal room temperature. Battery temperate should never exceed 104°F/40°C, it will lose about 5% of its capacity per day.

10. If you do not use the battery for a long time, be sure to make it a fully recharge every 3 months before storing again. Please keep the battery in cool and dry place when storing.

HOW TO CLEAN AND CARE THE LIGHT

- *Make sure to clean the dust and dirt on the light with soft damp cloth after every ride.
- *Water resistant is for rain water only. Do not submerge the battery or the whole light into water when cleaning.
- *Unplug the light, charger and cable once the battery is fully charged.

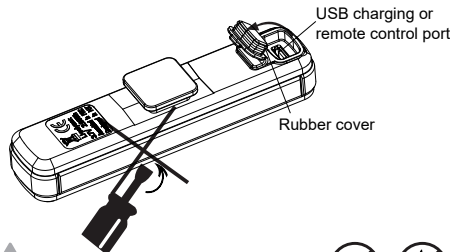

CAUTION: When riding at night, please follow the guidelines below:

- *Carrying a flash light is recommended.
- *Use caution when handing, the light may get hot.
- *Unplug the light if no use.
- *Unplug connector by the plug, never by the cable.
- *Do not dismantle the light.
- *Provide sufficient airflow to the light for cooling during use.
- *Do not control any part of the system under water.
- *Do not look directly at light.
- *Do not leave the light on and unattended.
- *Keep the light away from fire and combustible materials.
- *Do not store head unit when hot or straightway after use.
- *Unplug the USB cable when fully charged.
- *This light is for bicycle use only.

Chameleon RING RUN TIME

mode	Lumen	runtime	weight	charge time
Low	6	Up to 13 hours 50 mins		
Standard	12	Up to 7 hours 15 mins		
High	20	Up to 4 hours 50 mins	44 g	3 hours
Over drive	40	Up to 2 hours 30 mins		
Double click				
10%Flashing	10	Up to 39 hours 35 mins		
50%Flashing	20	Up to 9 hours 15 mins		
100%Flashing	40	Up to 4 hours 45 mins		
Strobe	10	Up to 21 hours 50 mins		
Double click				
Low Chameleon	30	Up to 5 hours 55 mins		
High Chameleon	65	Up to 3 hours		
Double click				
Blue	15	Up to 3 hours		
Green	44	Up to 2 hours 50 mins		
Red	30	Up to 2 hours 55 mins		
Yellow	65	Up to 1 hour 45 mins		
Purple	40	Up to 1 hour 40 mins		
White	50	Up to 1 hour 50 mins		
Double click				

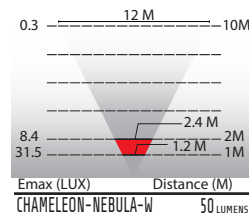
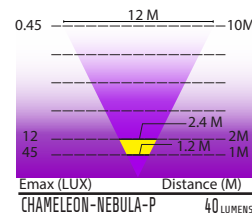
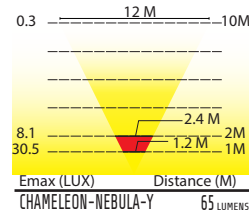
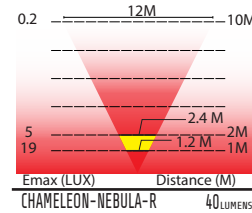
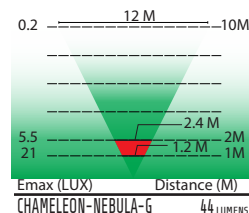
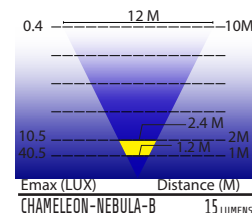
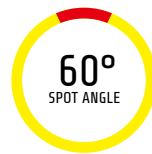
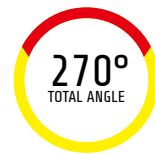

SIMPLE PROBLEMS ANALYSIS AND SOLUTION

1. Problem: The light is not on

Solution: Check if the battery still has power
Check if the power button is pressed hard

WARRANTY

MOON warrants to the original purchaser of this product that the product is free from defects in material and workmanship for a period of one year. This warranty does not apply to damage due to heat, physical damage resulting from abuse, neglect, improper repair, improper fit, or alterations of the fixture. This warranty is in lieu of all other agreements and warranties, general or specific, express or implied and no representative or person is authorized to assume liability on behalf of MOON in connection with the sale and use of this product.

MOON reserves the right to request the return of any product submitted for warranty consideration. All customers should contact the local dealer or regional distributor for warranty service.

To make a claim, first call local dealer or regional distributor. Some issues may be resolved upon the initial call. If return of the product is necessary, please refer to the following instructions:

*We recommend that items be sent by a traceable method (such as FedEx or UPS). MOON is not responsible for lost or misdirected packages.

*Please include your full contact information (name, address, phone number, and email [if applicable]), and a description of the issue.

*Address items to: local dealer or regional distributor

What is not covered: MOON Lights are covered by a ONE YEAR LIMITED WARRANTY from the date of purchase. This covers the lights and cables only. It does not cover the battery or battery internals.

Batteries are covered by 120 days warranty.

For more information please contact us at cs@moon-sport.com.